

SensorBlue

Smart Hygrometer User Guide



Model NO.: WS08



Free APP are available for both Android and IOS.

Before using the product, here is the 3 important points to keep the sensor accurate.

1. The app will request the photo and file permission because you can use photo to help remembering the location. App itself do not record any location history. Android user has to turn on location permission because Google make the BLE and GPS in the same Commands. SensorBlue is a simple app that don't need WIFI or GPS.
2. The sensor is an accurate humidity and temperature MEMS sensor. Please don't put it in the water.
3. The sensor detect the air temperature and humidity through the hole in the front, please don't cover it.



Please follow the following steps to use the product.

1. Please scan the QR code on the box or on the manual to download the APP.



2. Turn on the APP and make sure the Bluetooth of the APP is turned on.
3. Take off the battery sleeve, then the sensor starts to work.

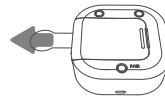

4. LONG PRESS to switch the °C/°F unit.



5. Tap "Find it" on your phone screen, the SMART HYGROMETER will alert.



6. Tap the "Add device" or "+" to add the hygrometer.

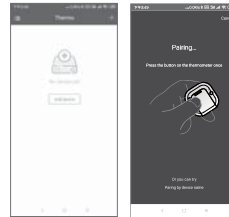

7. The APP is going to pair the device. After you press the button on the product, it will connect automatically.

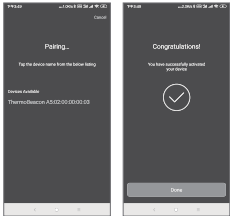

Note:
After pairing your smart hygrometer with SensorBlue APP, you can use the APP to check the temperature and humidity.

8. Tap the camera icon to take photos for the place where you put the sensor.
You can set up the desired alert temperature or humidity. When you connect the hygrometer with APP, you can read the instant temperature data and humidity data.



9. For some of the model which with the buzzer alert on device, if the temperature or humidity is out off range, it will have the alert on the device.
If you need to check the graphic or history, tap the temperature number or humidity number directly. Then you will see them.



10. If you need to set up the alert, tap the photo area. And set up the range.
Alert will happen on device if the temp is below or above the target.
Alert will happen on device if the humidity is below or above the target.

FAQ

- Q: The temperature and humidity date stuck, what is the problem?
A: This might be low battery, or the sensor broken. If you change a battery, still find this issue, please contact the seller.
- Q: Can I output the history data?
A: Yes, you can output the history data in CSV format. You can use Excel or Google Sheet to open it.
- Q: How many devices can I add in the app?
A: 100
- Q: Why I cannot receive the data in the living room when I put them in the garage?
A: The sensor uses 2.4G frequency to transmitter the data. This frequency is hard to get through the hard wall. Some as the Bluetooth earbuds.

- Q: Why I can't pair it in the Bluetooth setting?
A: The sensor use BLE technology. You have to pair it from the APP.
- Q: How many days will the history store in the device?
A: 100 days
- Q: Can multiple user use the sensor at the same time?
A: Yes, no matter you are the iPhone Use or Android user, you can connect them at the same time and get the data.
- Q: I change a new phone; how can I get the history back?
A: The history data is in the sensor for 100 days until you clear it or you change the battery. You can download it again.

FCC Statement

This equipment has been tested and found to comply with the limits for a Class B digital device, pursuant to Part 15 of the FCC Rules. These limits are designed to provide reasonable protection against harmful interference in a residential installation. This equipment generates uses and can radiate radio frequency energy and, if not installed and used in accordance with the instructions, may cause harmful interference to radio communications. However, there is no guarantee that

interference will not occur in a particular installation. If this equipment does cause harmful interference to radio or television reception, which can be determined by turning the equipment off and on, the user is encouraged to try to correct the interference by one or more of the following measures:
- Reorient or relocate the receiving antenna.
- Increase the separation between the equipment and receiver.
- Connect the equipment into an outlet on a circuit different from that to which the receiver is connected.
- Consult the dealer or an experienced radio/TV technician for help.

This device complies with part 15 of the FCC Rules. Operation is subject to the following two conditions:
(1) This device may not cause harmful interference, and
(2) this device must accept any interference received, including interference that may cause undesired operation.

Changes or modifications not expressly approved by the party responsible for compliance could void the user's authority to operate the equipment.

Technical Spec

Temperature Range	-20~55°C [-4~130°F]
Humidity Range	0~100%RH
Accuracy	Temp: ±0.5°C/1°F Humidity: ±3.0%
Wireless Range	Bluetooth 5.0
Free APP Control	Yes
Sensor Type	MEMS
Material	ABS
Battery	1*CR2477
Alarm	YES
History Memory Time	Every 10 Mins
Battery Life	About 1 Year

